

CENTURY PARK NORTH ADA FLOOR PLAN

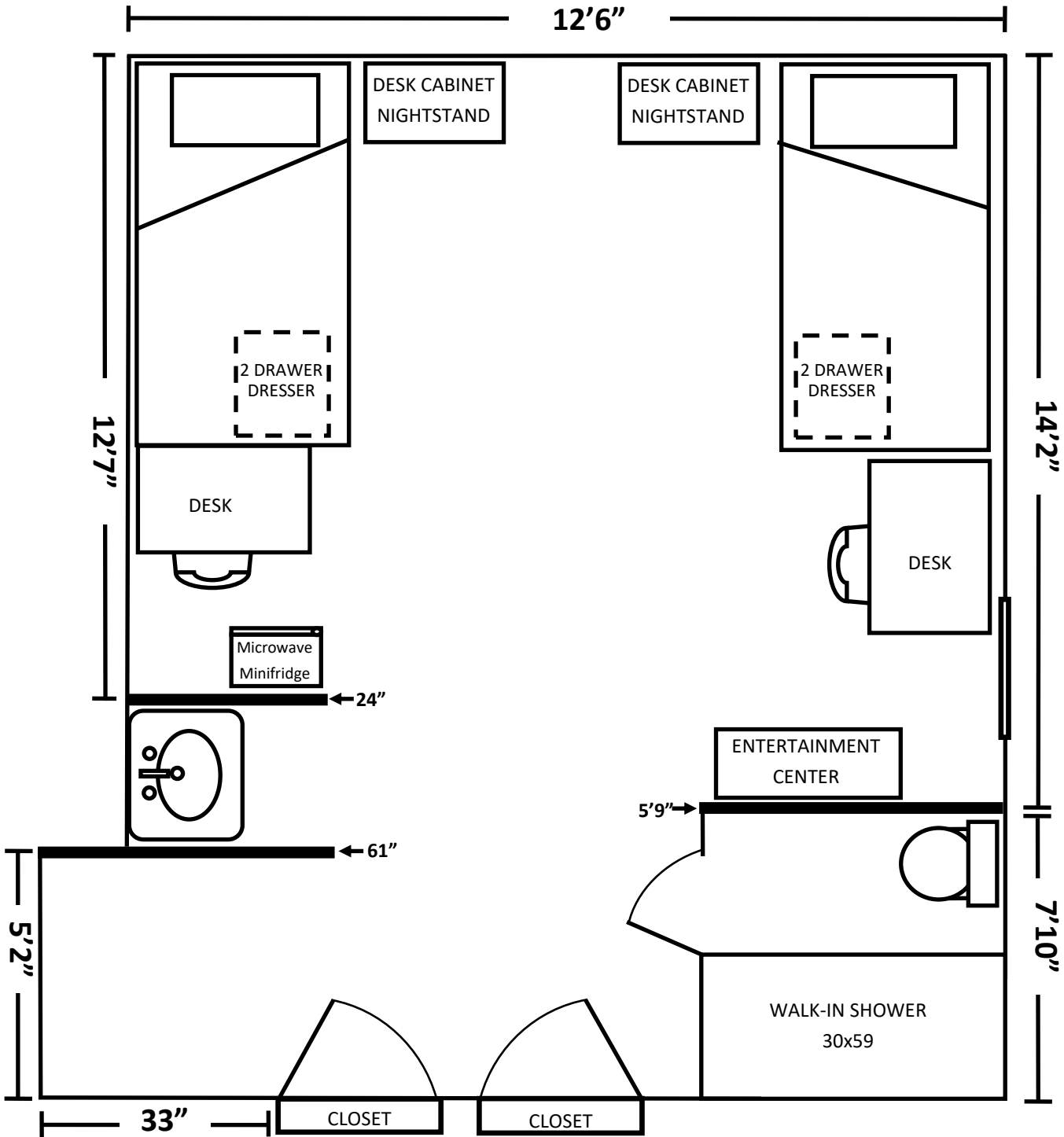

Laundry Facilities on the first floor; Lounges on each floor

| | | | |
|-----------------------|-------------------------|----------------------------------|-----------------------|
| 2 Drawer Dresser | D 24.5", W 29.5", H 22" | Entertainment Center | D 14", W 24", H 48" |
| Desk | D 24", W 32", H 30" | Desk Cabinet/Nightstand | D 24", W 17", H 30" |
| Head/Foot Board | W 38", H 39" | Adjustable Bed frame | L 85.5", W 38", H 33" |
| Bed Mattress | W 33", L 80" | Closets | D 23", W 36", H 85" |
| Vanity | D 24", W 36", H 33" | Private Bath with Walk-In Shower | |
| Microwave/Mini-Fridge | D 18", W 18", H 43" | Entry Door | W 35.75", H 79" |

Blinds in all rooms

Windows: All floors W 38", H 64", rooms 407-420: W 70", H 64" (base of window to floor varies: 34"-40")